

# Actulux



Røgventilation

Smoke vent

Åbningssystemer

Savunpoisto

24V - 48V - 230V

RWA

Opening systems

Exutoire de fumee

Öffnungssysteme

Systèmes d'ouverture

Elektrisk

Avasjärjestelmät

Electrical

Kædemotorer

Elektrisch

Chain drives

Kettenantrieben

Opérateurs de la chaîne

**Product Overview**

# Table of Content

TRAVERSE MOUNTED SYSTEMS	PAGE
SA Power Mini	4-5
SA Power Single	6-7
SA Power Double	8-9
SA Power Large	10-11
SA Roof Access	12-13
SA Basic Set	14-15
CHAIN DRIVES	
HCM - Chain Drive	16-17
HCV - Chain Drive	18-19
HCV - Door Drive	20-21
SPINDLE DRIVES	
JM-DC3 - Spindle Drive	22-23
CONTROL PANELS (EN12101-10)	
Type SVM 24V, 1 fire-/comfort group	24-25
Type SV 24V/48V, 2 fire-/comfort groups	26-27
CERTIFICATES	
EC Certificate of Conformity for Power Supplies	28-29

# Actulux Products

## Opening Systems

### Traverse mounted (EN 12101-2 prepared)



### Side mounted 24V/230V



### Door mounted 24VDC



## Control Panels EN 12101-10 Certified



# Electrical Opening System - SA Power Mini

maximum stability and minimum need for space

EN12101-2



**Actulux**

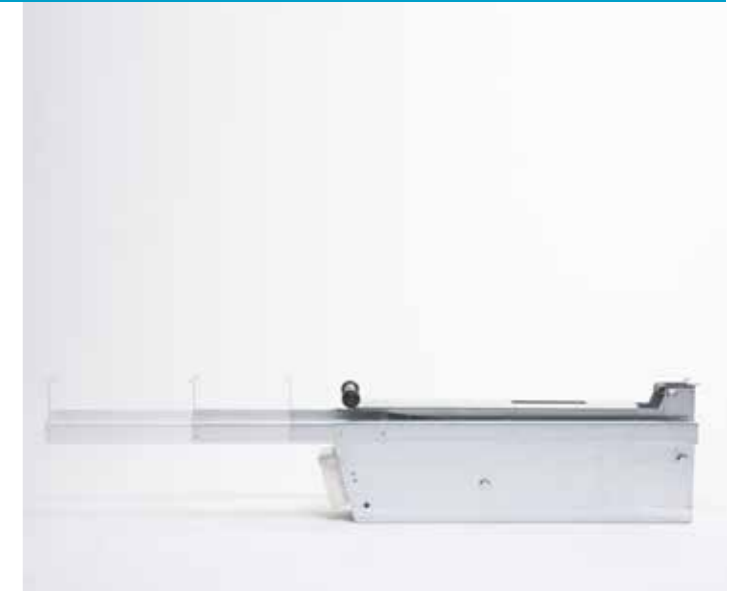

## MAXIMUM STABILITY AND POWER

SA Power Mini is based on a flexible unique geometrical movement by means of an electrical actuator.

The SA Power Mini gives a maximum stability and power performance for opening and closing. The traverse length is 100% adjustable.

The opening system is especially designed for small and medium size skylights, domes and smoke hatches in buildings, staircases etc.

The opening system has an elegant design and takes no space in the room under the skylight or smoke hatch.

Model	Product no.	Power supply	Traverse length (build-in dimen.)	Opening angle (fire)	Opening force 24VDC (cover weight incl. snow)	Opening force 48VDC (cover weight incl. snow)	Max. cover weight (closing force after full fire opening)	Temperature
SA Power Mini 160°	221000	24VDC / 2.5 A 48VDC / 1.25A	70-110 cm (adjustable)	160° (*)	70-100 cm: 130 kg 101-110 cm: 110 kg		70-100 cm: 30 kg 101-110 cm: 25 kg	-5°C - +55°C (+75°C)**
SA Power Mini 130°	221100			130° (*)				
SA Power Mini+ 160°	221400	24VDC / 4A 48VDC / 2A	70-110 cm (adjustable)	160° (*)	70-100 cm: 190 kg 101-110 cm: 170 kg	70-100 cm: 200 kg 101-110 cm: 180 kg	70-100 cm: 70 kg 101-110 cm: 65 kg	-5°C - +55°C (+75°C)**
SA Power Mini+ 130°	221500			130° (*)				

(\*) As option a special "actuator stop kit" can easily be post mounted to reduce the max. opening angle in any angle  
 \*\* Requires special lubrication

## FEATURES

Very easy and flexible mounting

Input voltage: 24V - max. 2.5A or 48V - max. 1.25A (Mini)      24V - max. 4A or 48V - max. 2A (Mini+)

Size: Length 70-110 cm / Width 15 cm / Height 20 cm

Opening angle for fire position: 90° - 160°

Opening time: max. 60 seconds

Designed for min. 10.000 comfort openings and min. 1.000 fire openings

Degree of protection: IP54      Operation mode: S3 25% duty cycle

Meets the demands acc. to EU standard EN12101-2

Unique and elegant design (takes no space in the room under the upstand)

Incl. overload protection

Options: Tandem operation or Synchro operation

Galvanized or white colour

No maintenance required, only yearly inspection acc. to local legislation

# Electrical Opening System - SA Power Single

maximum stability and minimum need of space

EN12101-2



**Actulux**



The opening system sets new standards within the electrical opening and closing of skylight, smoke hatch, glass roof and façade solutions etc. where there is a need for fire and comfort ventilation, according to the European Standard EN 12101-2.

### MAXIMUM STABILITY AND POWER

The opening system is based on a unique geometrical movement by means of an electrical actuator, which is fitted in a system for which a patent is applied. This system gives a maximum stability and power exploitation both for opening and closing.

The opening system is especially suitable for medium and large skylights.

### SINGLE AND COMPACT OPENING PRINCIPLE

The opening system has an elegant design, which with its single and compact opening principle demands a minimum of space in closed position as well as in operation (It does not take space in the room under the skylight or smoke hatch). This gives the possibility to pre-install the opening system.

### BUILT-IN ELECTRONIC CURRENT LIMITER

The electrical actuator is connected with a built-in electronic current limiter (type LIP) that works as an overload protector by end stop and locking. At the same time, it gives the possibility to determine the current consumption as well as the opening time.

Model	Power supply	Traverse length (build-in dimen.)	Opening angle (fire)*	Opening force (cover weight incl. snow)** Traverse length: kg	Max. cover weight (closing force after full fire opening)*** Traverse length: kg	Temperature
SA Power Single	24VDC / 4A 48VDC / 2A	88-200 cm	Up to 160°	88-120 cm: 300 kg 130-150 cm: 220 kg 160-180 cm: 200 kg 190-200 cm: 150 kg	88-120 cm: 55 kg 130-150 cm: 40 kg 160-180 cm: 35 kg 190-200 cm: 30 kg	-5°C - +55°C (+75°C)****

(\*) As option a special "actuator stop kit" can easily be post mounted to reduce the max. opening angle in any angle

(\*\*) Depending on geometry and construction

(\*\*\*) Special "closing kit" can be mounted to improve closing power

(\*\*\*\*) Requires special lubrication

Note: 2 pcs. of opening systems can be mounted in the same window/skylight - then figures in above table can be approx. doubled

## FEATURES

For comfort and smoke ventilation in domes, skylights and smoke hatches

Very easy and flexible mounting

Opening angle: 0° to 160°

Extremely low noise level

Opening time: max. 60 seconds

Designed for min. 10.000 comfort openings and min. 1.000 fire openings

Degree of protection: IP54

Corrosionclass: C2 (pregalvanized)

Operation mode: S3 25% duty cycle

Meets the demands acc. to EU standard EN12101-2

Unique and elegant design (takes no space in the room under the upstand)

Incl. overload protection

Galvanized

No maintenance required, only yearly inspection acc. to local legislation

Patented pending opening system

# Electrical Opening System - SA Power Double

maximum stability and minimum need of space

EN12101-2



**Actulux**



The opening system sets new standards within the electrical opening and closing of skylight, smoke hatch and glass roof etc. where there is a need for fire and comfort ventilation, according to the European standard EN 12101-2.

### MAXIMUM STABILITY AND POWER

The opening system is based on a unique geometrical movement by means of an electrical actuator, which is fitted in a system for which a patent is applied. This system gives a maximum stability and power exploitation both for opening and closing.

The opening system is especially suitable for medium and large skylights with double flap.

### UNIQUE DESIGN DEMANDS LESS SPACE

The opening system has an elegant design, which with its single and compact opening principle demands a minimum of space in closed position as well as in operation (It does not take space in the room under the skylight or smoke hatch). This gives the possibility to pre-install the opening system.

### BUILT-IN ELECTRONIC CURRENT LIMITER

The electrical actuator is connected with a built-in electronic current limiter (type LIP) that works as an overload protector by end stop and locking. At the same time, it gives the possibility to determine the current consumption as well as the opening time.

## FEATURES

Input: 48V DC or 24V DC

Low current consumption with intelligent adjustment by current limiter type LIP (48V = max. 2x2A / 24V = max. 2x4A)

For skylight sizes: Width 160-300 cm and length (hinge side) up to 250 cm

Lifting power up to 300 kgs each lid incl. snow load

Opening angle: 0° to 95°

Temperature: -5°C - +55°C (+75°C Requires special lubrication)

Opening time: max. 60 sec.

Degree of protection: IP54

Operation mode: S3 25% duty cycle

Meets the demands according to EU Standard EN12101-2

Extremely low noise level

No maintenance, only min. one yearly inspection according to the legislation in force

Patent pending opening system

Unique design with small space requirement, which gives the possibility to pre-install

# Electrical Opening System - SA Power Large

maximum stability and minimum need of space

EN12101-2

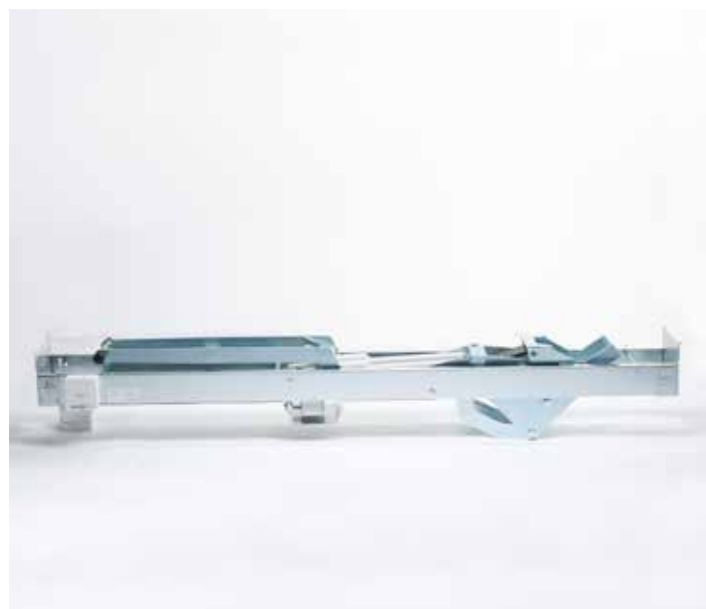

**Actulux**



With the SA Power Large Actulux is again raising the standard within the electrical opening and closing of skylights, smoke hatches and glass roofs where there is a need for fire and comfort ventilation, according to the European standard EN 12101-2.

### UNIQUE GEOMETRICAL MOVEMENT

The opening system is based on a unique geometrical movement by means of two electrical actuators, which are fitted in a system for which a patent is applied. This system gives a maximum stability and power exploitation both for opening and closing.

The opening system is especially suitable for large single flap skylights up to 250 cm width.

### ELEGANT DESIGN AND COMPACT OPENING PRINCIPLE

The opening system has an elegant design, which with its single and compact opening principle demands a minimum of space in closed position as well as in operation (It does not take space in the room under the skylight or smoke hatch). This gives the possibility to pre-install the opening system.

### BUILT-IN ELECTRONIC CURRENT LIMITER

The electrical actuators are connected with a built-in electronic current limiter (type LIP) that works as an overload protector by end stop and locking. At the same time, it gives the possibility to determine the current consumption as well as the opening time.

## FEATURES

Input: 48V DC or 24V DC

Low current consumption with intelligent adjustment by current limiter type LIP (48V=max. 4A / 24V=max. 8A)

For skylight sizes: Width 150-250 cm and length (hinge side) up to 250 cm

Lifting power up to 320 kgs lid weight incl. snow load

Opening angle: 0° to 160°

Temperature: -5°C - +55°C (+75°C Requires special lubrication)

Opening time: max. 60 seconds

Degree of protection: IP54      Operation mode: S3 25% duty cycle

Meet the demands according to EU Standard EN12101-2

Extremely low noise level

No maintenance, only min. one yearly inspection according to the legislation in force

Patent pending opening system

Unique design with small space requirement, which gives the possibility to pre-install

# Electrical Opening System - SA Roof Access

maximum stability and minimum need of space

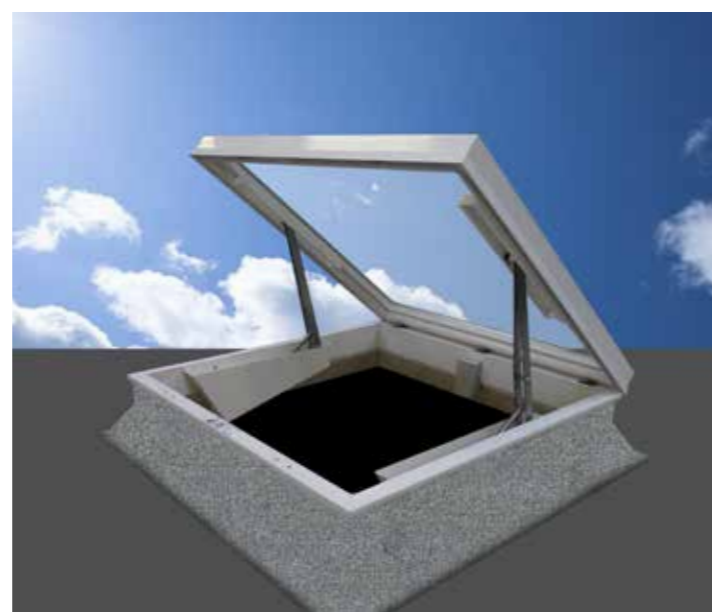

**Actulux**



## FOR ROOF ACCESS

The opening system is developed for roof hatch & domes to make easy access to the roof.

## ELEGANT DESIGN AND COMPACT OPENING PRINCIPLE

The opening system has an elegant design. With its single and compact opening principle it demands a minimum of space, and possibility for pre-installation or retrofit on an existing hatch.

## MAXIMUM STABILITY AND POWER

The opening system is based on a unique geometric movement by means of an electrical actuator mounted in both sides of the upstand.

This system gives maximum stability and power exploitation both for opening and closing.

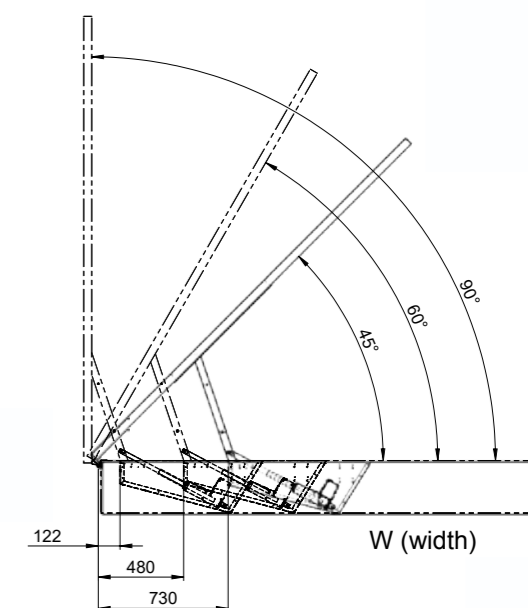

Model	Product no.	Power Supply	Cover size (W) examples	Opening angle	Maximum weight (at 140 cm width)	Temperature
SA Roof Access for 24V or 48V	222239	24V - 2x2.5A (5A) 48V - 2x1.25A (2.5A)	80 - 240 cm	45° - 90°	160 kg (210 kg)	-5°C - +55°C (+75°C)*
SA Roof Access for 230V	222223 222226	80W - 24V/2x1.5A (3A) 150W - 24V/2x3A (6A)			160 kg 210 kg	
SA Roof Access for 230V incl. remote control	222233 222236	80W - 24V/2x1.5A (3A) 150W - 24V/2x3A (6A)			160 kg 210 kg	

\*Requires special lubrication

## FEATURES

For roof access - painted in RAL 9010 WHITE

Very easy and flexible mounting

Opening angle: 45° to 90°

Extremely low noise level

Degree of protection: IP54

Operation mode: S3 25% duty cycle

From motor unit: 200 cm (Max. cable length from motor to Lip control box overload unit)

Dimensions (l x h x w): 800 x 355 x 100 mm

Incl. overload protection

No maintenance required

# Electrical Opening System - SA Basic Set

## 24/36/48VDC Intelligent LIP + High Performance Actuator

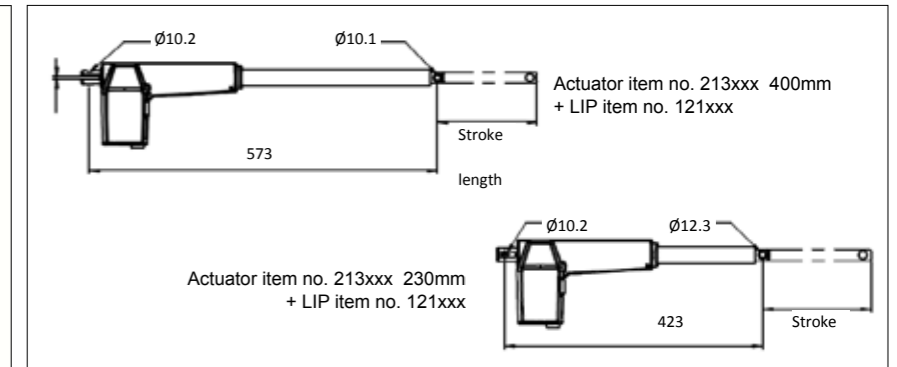
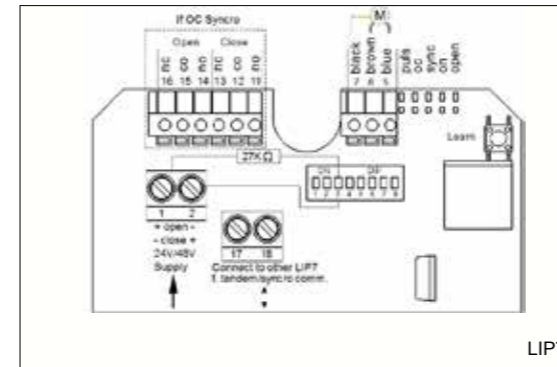

### INTELLIGENT ELECTRONIC UNIT

The SA Basic set consist of an electrical high performance actuator and an Intelligent Overload unit (LIP). The LIP is a separate intelligent electronic unit, mounted in a small junction box to be connected between the actuator and the supply (24/36/48VDC).

The LIP is needed in any application to avoid damage of the actuator and to get full benefit of the intelligent features (overload unit and current limiter in the same unit).

Model	Power supply VDC / Max. A	Push force (Max. N)	Pull force (Max. N)	Self-locking (Min. N)	Temperature	Stroke length (mm)	LIP Setting DIP Set 1-2
SA Basic Set – 7000N (Aktuator+LIP7 BA) # 213206	24VDC 36VDC 48VDC	7000	4000	2000	-5°C - +55°C (+75°C)*	Max. 400 Std. 400	OFF – ON
	4A 3A 2A						
SA Basic Set – 7000N (Aktuator+LIP7 TA) # 213207	24VDC 36VDC 48VDC	7000	4000	2000	-5°C - +55°C (+75°C)*	Max. 400 Std. 400	OFF – ON
	4A 3A 2A						
SA Basic Set – 7000N (Aktuator+LIP7 BA) # 213208	24VDC 36VDC 48VDC	7000	4000	2000	-5°C - +55°C (+75°C)*	Max. 330 Std. 330	ON – OFF
	3A 2,3A 1,5A						
SA Basic Set – 7000N (Aktuator+LIP7 TA) # 213209	24VDC 36VDC 48VDC	7000	4000	2000	-5°C - +55°C (+75°C)*	Max. 330 Std. 330	ON – OFF
	3A 2,3A 1,5A						
SA Basic Set – 7000N (Aktuator+LIP7 BA) # 213211	24VDC 36VDC 48VDC	7000	4000	4000	-5°C - +55°C (+75°C)*	Max. 230 Std. 230	ON – ON
	2,5A 1,9A 1,25A						
SA Basic Set – 7000N (Aktuator+LIP7 TA) # 213212	24VDC 36VDC 48VDC	7000	4000	4000	-5°C - +55°C (+75°C)*	Max. 230 Std. 230	ON – ON
	2,5A 1,9A 1,25A						
SA Basic Set – 1600N (Aktuator+LIP7 TA) # 213213	24VDC 36VDC 48VDC	1600	1600	4000	-5°C - +55°C (+75°C)*	Max. 230 Std. 230	ON – OFF
	1,0A 0,75A 0,5A						
SA Basic Set – 1300N (Aktuator+LIP7 TA) # 213214	24VDC 36VDC 48VDC	1300	1300	2000	-5°C - +55°C (+75°C)*	Max. 400 Std. 330	OFF – ON
	1,0A 0,75A 0,5A						
SA Basic Set – 2600N (Aktuator+LIP7 TA) # 213215	24VDC 36VDC 48VDC	2600	2600	2000	-5°C - +55°C (+75°C)*	Max. 400 Std. 330	ON – ON
	1,5A 1,13A 0,75A						

As option a special "actuator stop kit" can easily be post mounted to reduce the stroke length in any length  
\*Requires special lubrication

### FEATURES

- Input voltage: 24VDC or 48VDC (automatically detected by LIP)
- Input current consumption (max. A) - see specification table
- Electronic overload protection + mechanical end stop switches
- Opening time to full stroke length = max. 60 seconds (for EN12101-2 approval)
- Special Actulux 300°C heat solution in the actuator (for EN 12101-2 approval)
- Designed for min. 10.000 comfort openings and min. 1.000 fire openings
- Degree of protection: IP54      Operation mode: S3 25% duty cycle
- Extremely silent operation
- "Actuator stop kit" as option for post mounting for free stroke length reduction
- No maintenance required

# Electrical Window Opener - Chain Drive 300N-300mm

HCM 24-36-48VDC / HCMA 230VAC / HCMARemote 230VAC



HCMAR

- For roof windows, façades and skylights
- Compact and elegant design
- Power supply:
  - 24-36-48VDC (HCM)
  - 230VAC (HCMA /HCMAR<sub>remote</sub>)
- Programmable options:
  - Synchro mode (up to 4 drives)
  - Force (push, pull, soft close)
  - Speed
  - Stroke length
  - Soft close length
- 2 wire line monitoring (HCM)
- Soft close function

- Stroke length: 300mm as standard (can be reduced by programming)
- Pushing/pulling force: 300N as standard (can be reduced by programming)
- Built-in electronic overload protection
- Low noise level
- Tested to min. 11.000 cycles
- 2.5m silicon cable
- Housing in white coated aluminium
- Symmetrical chain exit (in proportion to the housing)
- Integrated receiver + external remote control (HCMAR)
- Receiver is compatible with Wind & Rain Sensor #111960 and #111961



HCM / HCMA



HCMAR<sub>remote</sub>

Model	Power supply	Pushing / pulling force	Stroke length	Soft Close	Locking pressure	Protection	Temperature	Speed mm / sec.	Size (LxWxH mm)
				Factory setting					
HCM 300N/300mm	24VDC / 0.8A 36VDC / 0.6A 48VDC / 0.4A	300 / 300 N	300 mm	150 N 50 mm	2000 N	IP 32	-25° C - +75° C	6.8	451 x 48 x 34
HCMA 300N/300mm	230VAC / 15W	300 / 300 N	300 mm		2000 N	IP 32	-25° C - +75° C	6.8	451 x 48 x 34
HCMAR 300N/300mm (integrated receiver + external remote control)	230VAC / 15W	300 / 300 N	300 mm		2000 N	IP 32	-25° C - +75° C	6.8	451 x 48 x 34

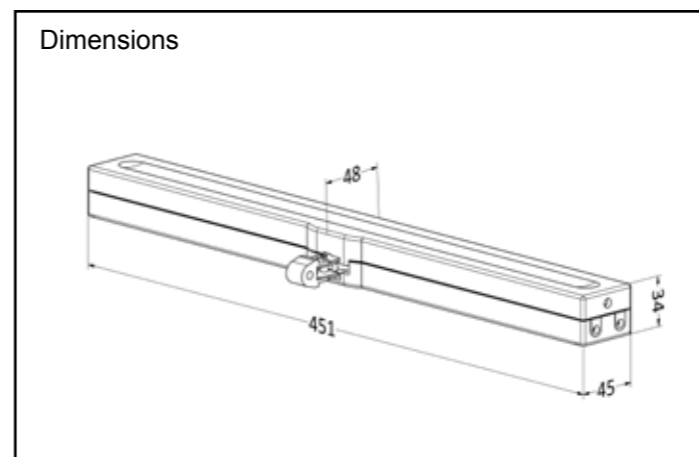

Dimensions

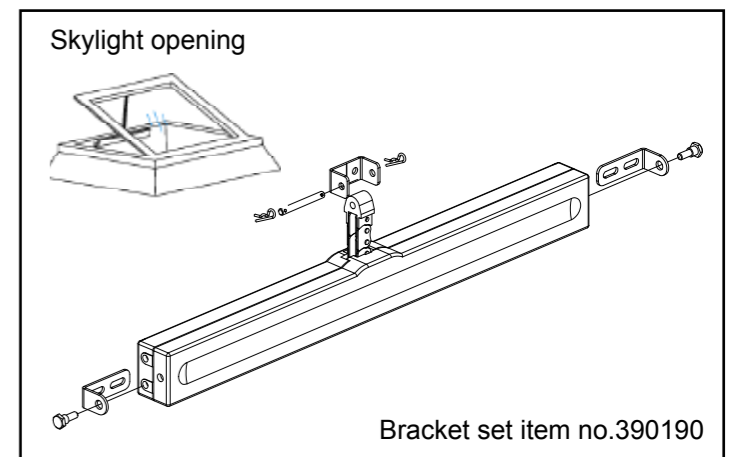

Skylight opening

Bracket set item no.390190

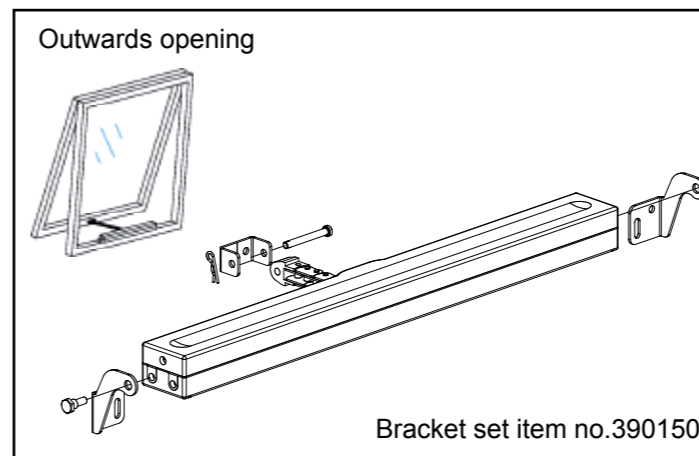

Outwards opening

Bracket set item no.390150

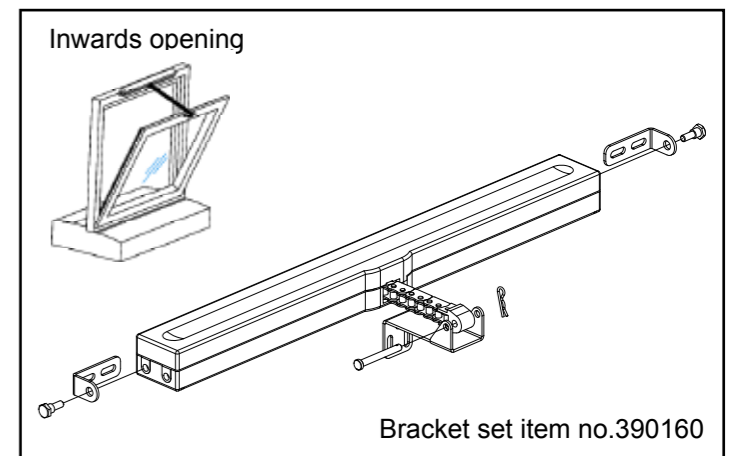

Inwards opening

Bracket set item no.390160

# Electrical Window Opener - Chain Drive

HCV 24-36-48VDC / HCVA 230VAC / HCVAR<sub>remote</sub> 230VAC

EN12101-2



HCVAR<sub>remote</sub>

HCV/HCVA

- For roof windows, façades and skylights
- Compact and elegant design
- Power supply:
  - 24-36-48VDC (HCV)
  - 230VAC (HCVA / HCVAR<sub>remote</sub>)
- Programmable options:
  - Synchro mode (up to 4 drives)
  - Force (push, pull, soft close)
  - Speed
  - Stroke length
  - Soft close length
- 2 wire line monitoring (HCV)
- Soft close function

- Stroke length: 350-600-800-1000mm as standard (can be reduced by programming)
- Pushing/pulling force: 500N as standard (can be reduced by programming)
- Built-in electronic overload protection
- Low noise level
- Tested to min. 11.000 cycles
- Two different speeds - one for natural ventilation and one for smoke & heat ventilation
- 2.5m Silicon cable
- Housing made of anodized aluminium
- Tested according to EN12101-2 (HCV)
- Integrated receiver + external remote control (HCVAR)

Model	Power supply	Pushing / pulling force	Stroke length	Soft Close	Locking pressure	Pro-tection	Temperature	Speed (mm/sec.)		Size (LxBxH mm)
								Natural	Smoke & Heat (High Speed)	
HCV 500N / 350mm	24VDC / 1.4A 36VDC / 1.05A 48VDC / 0.7A	500 / 500 N	350 mm	Factory setting	2000 N	IP 32	-25° C - +75° C	7		436 x 51 x 41
HCV 500N / 600mm	24VDC / 1.4A 36VDC / 1.05A 48VDC / 0.7A	500 / 500 N	600 mm	200 N 50 mm	2000 N	IP 32	-25° C - +75° C	7	10	561 x 51 x 41
HCV 500N / 800mm	24VDC / 1.4A 36VDC / 1.05A 48VDC / 0.7A	500 / 500 N	800 mm		2000 N	IP 32	-25° C - +75° C	10	14*	661 x 51 x 41
HCV 500N / 1000mm	24VDC / 1.4A 36VDC / 1.05A 48VDC / 0.7A	500 / 500 N	1000 mm		2000 N	IP 32	-25° C - +75° C	10	17*	766 x 51 x 41
HCVA 500N / 350mm	230VAC / 30W	500 / 500 N	350 mm		2000 N	IP 32	-25° C - +75° C	7		586 x 51 x 41
HCVA 500N / 600mm	230VAC / 30W	500 / 500 N	600 mm		2000 N	IP 32	-25° C - +75° C	7		711 x 51 x 41
HCVA 500N / 800mm	230VAC / 30W	500 / 500 N	800 mm		2000 N	IP 32	-25° C - +75° C	10		811 x 51 x 41
HCVA 500N / 1000mm	230VAC / 30W	500 / 500 N	1000 mm		2000 N	IP 32	-25° C - +75° C	10		916 x 51 x 41
HCVAR 500N / 350mm**	230VAC / 30W	500 / 500 N	350 mm		2000 N	IP 32	-25° C - +75° C	7		586 x 51 x 41***
HCVAR 500N / 600mm**	230VAC / 30W	500 / 500 N	600 mm		2000 N	IP 32	-25° C - +75° C	7		711 x 51 x 41***
HCVAR 500N / 800mm**	230VAC / 30W	500 / 500 N	800 mm		2000 N	IP 32	-25° C - +75° C	10		811 x 51 x 41***
HCVAR 500N / 1000mm**	230VAC / 30W	500 / 500 N	1000 mm		2000 N	IP 32	-25° C - +75° C	10		916 x 51 x 41***

\* Note: Reduced max. force to achieve 60 sec. opening time

\*\* Integrated receiver + external remote control

\*\*\* L: +Antenna 35 mm

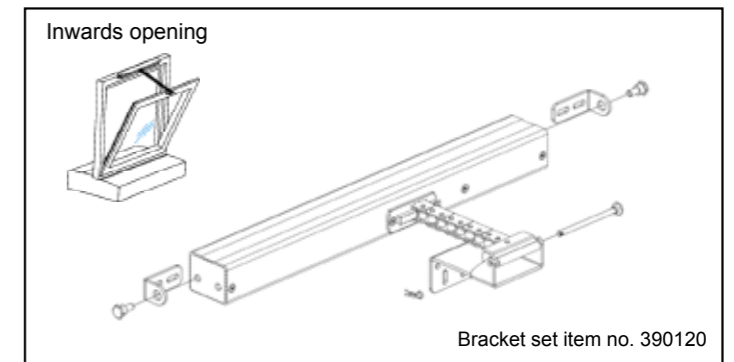
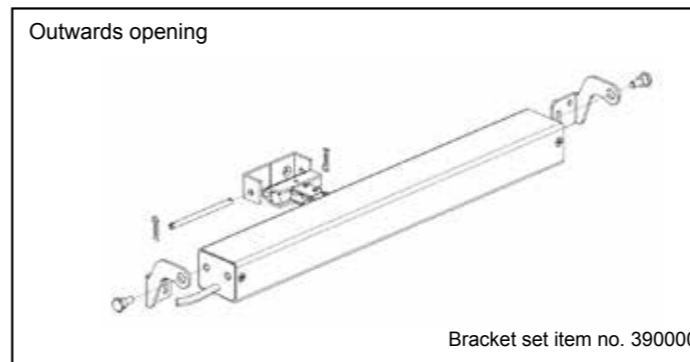
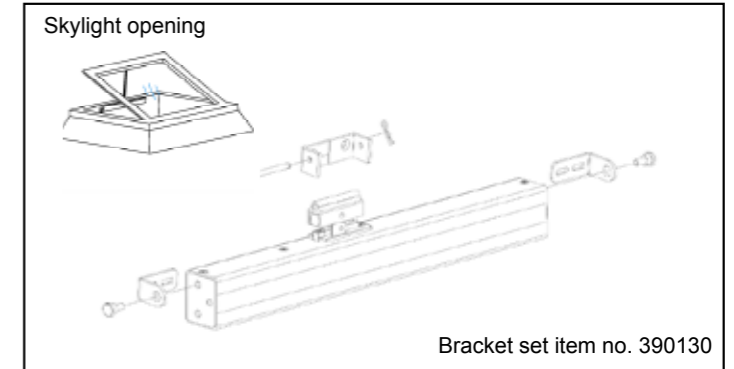
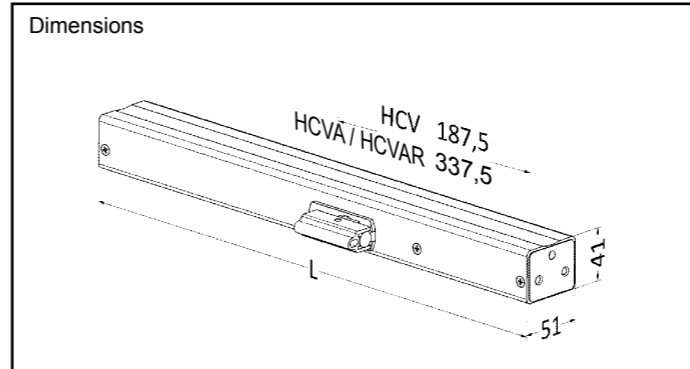
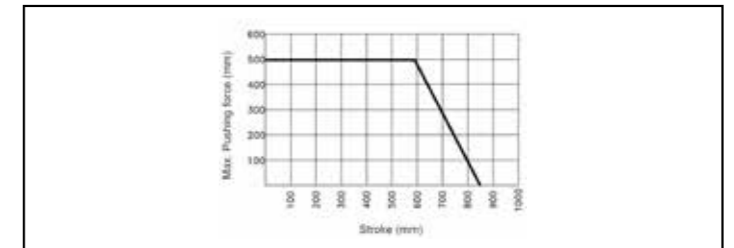

# Electrical Door Drive - Chain Drive

HCV-Door 24-36-48VDC

EN12101-2



Model	Power supply	Pushing/pulling force (N)	Opening angle	Locking pressure	Protection	Temperature	Speed (mm/sec.)		Size (mm) (LxWxH)
Door Drive							Natural	Smoke & Heat	
HCV 500/600mm	24VDC / 1.4A 36VDC / 1.05A 48VDC / 0.7A	500 / 500 N	90°	2000 N	IP 32	-25° C - +75° C	7	10	587 x 82 x 41

Dimensions

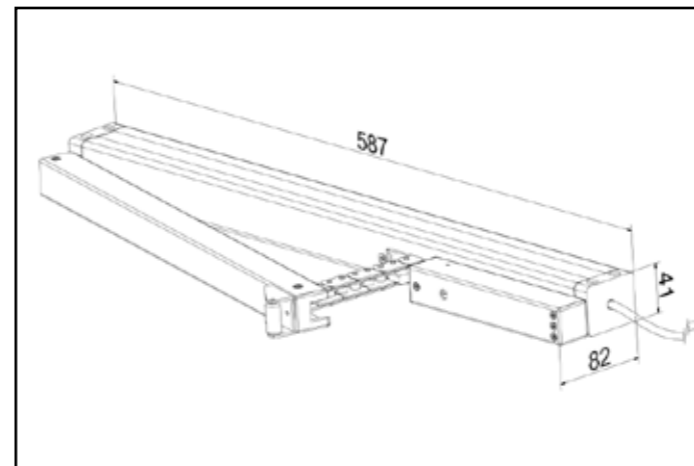

Bracket set for Inwards opening

item no.390061

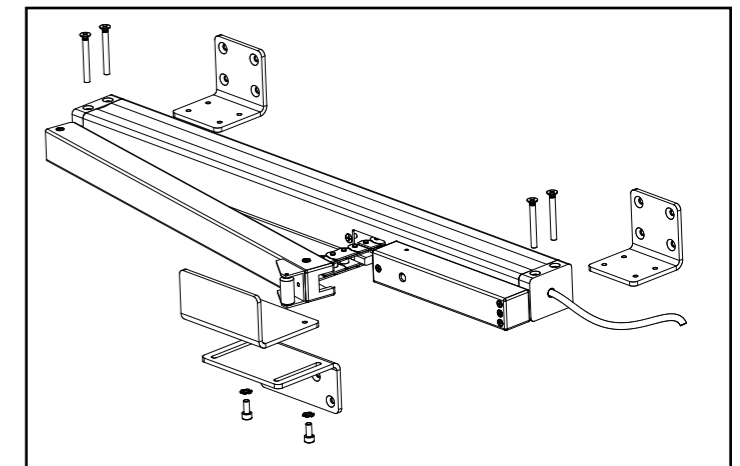

**FEATURES:**

- For all doors
- Compact and elegant design
- Built-in electronic overload protection
- Power supply 24-36-48VDC
- 2 wire line monitoring
- Up to 500N force at chain entrance point
- 600 mm chain length
- Soft Close function (reduced closing speed)
- 2.5 m Silicone cable
- Housing made of anodized aluminium
- Tested according to EN12101-2

# 318061



Outwards opening

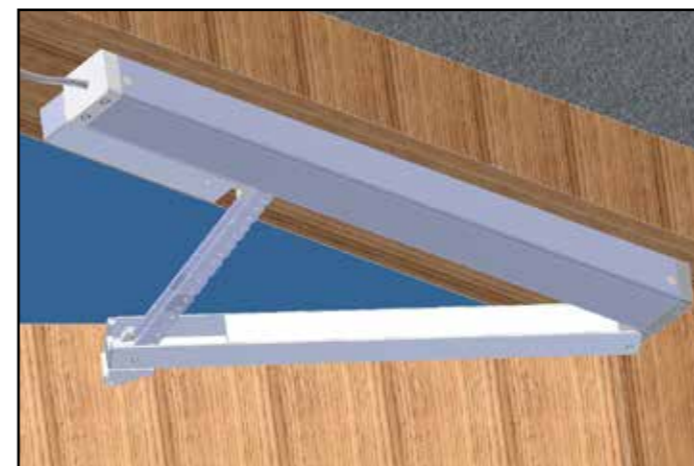

Inwards opening

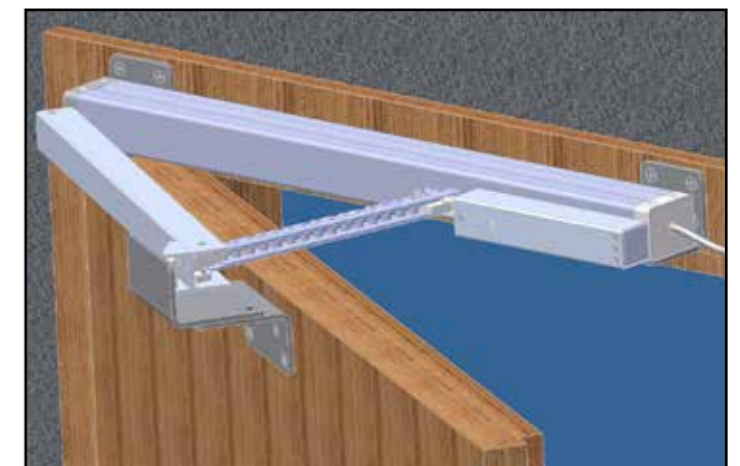

# Electrical Window Opener - Spindle Drive

JM-DC3 24 VDC

EN12101-2

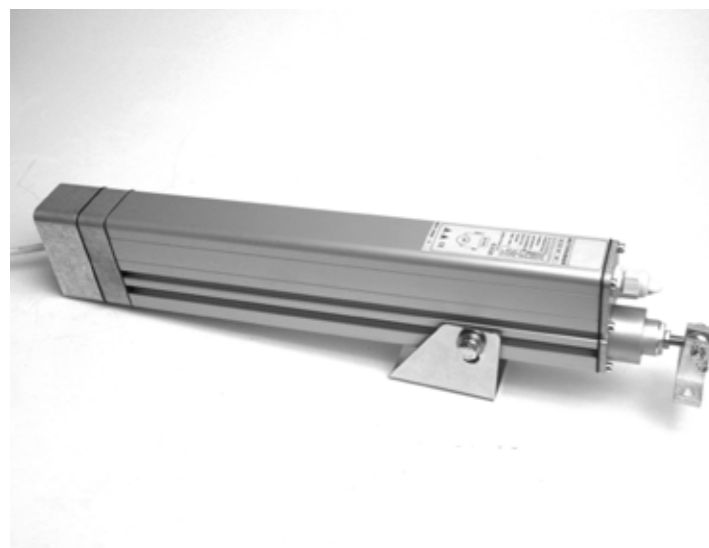

## FEATURES:

- For all windows and skylights
- Built-in end switch
- Electronic protection against overload
- Spindle drive is permanent lubricated
- Stroke from 300mm to 1000mm
- 800mm opening within < 60 sek.
- Push- / pulling force 900N or 1600N
- Locking force 3500N
- Power supply 24VDC
- 3,5 m Silicon cable
- Tube made of anodized aluminium
- Input voltage according to EN 61558-2-6 (24VDC +30% / - 20%)
- Requirements according to EN 12101-2

Model	Power supply*	Push / pulling force	Stroke length (mm)	Locking force	Protection	Temperature	Speed (mm/sec.)	Size (mm) (LxWxH)
JM-DC3 900N-300mm	24 VDC / 2,0A (2,5A)	900N/900N	300	3500N	IP 65	-15° C - 75° C	13,6	495 x 86 x 47
JM-DC3 900N-500mm			500					695 x 86 x 47
JM-DC3 900N-800mm			800					995 x 86 x 47
JM-DC3 900N-1000mm			1000					1195 x 86 x 47
JM-DC3 1600N-500mm	24 VDC / 4,0A (5,0A)	1600N/1600N	500	3500N	IP 65	-15° C - 75° C	13,6	695 x 86 x 47
JM-DC3 1600N-800mm			800					995 x 86 x 47
JM-DC3 1600N-1000mm			1000					1195 x 86 x 47

## Dimensions

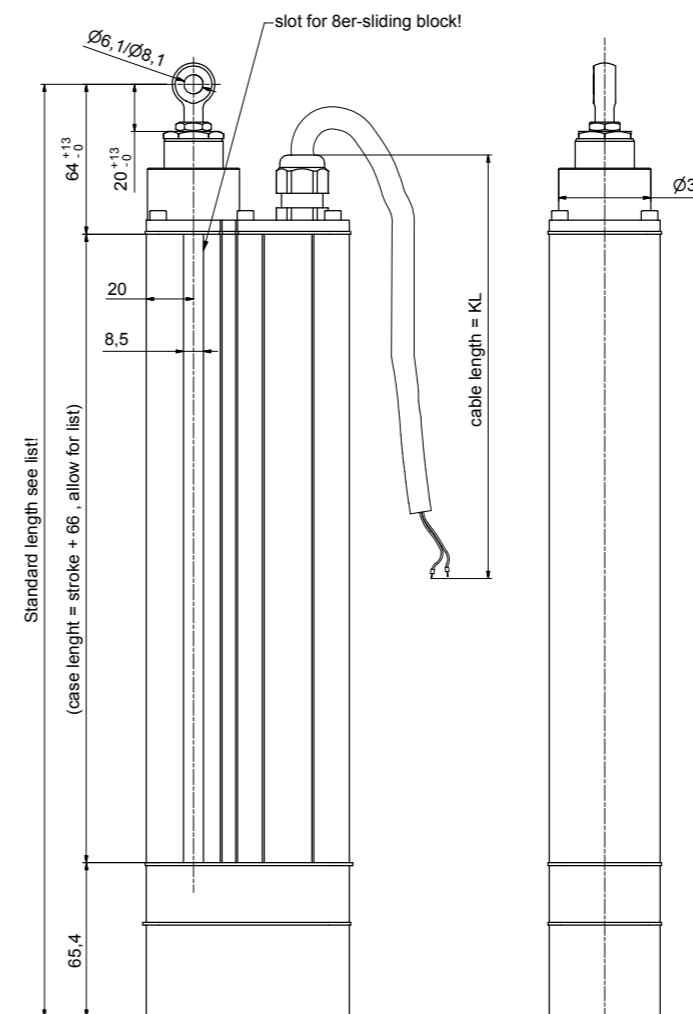

## Max. pushing force at 900N motor

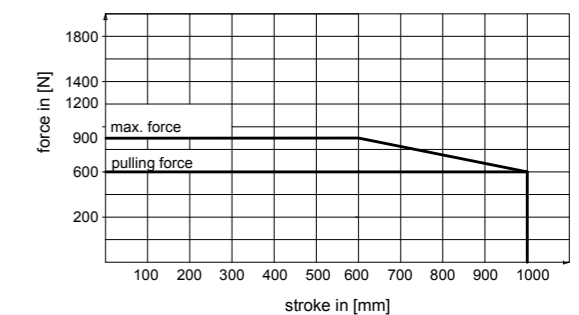

## Max. pushing force at 1600N motor

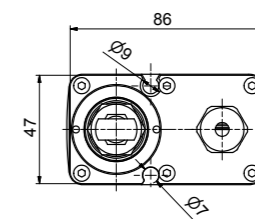
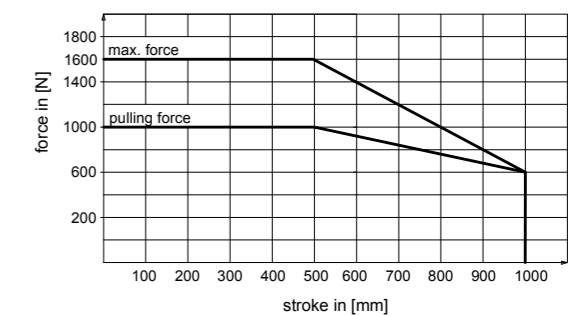

## FEATURES

\* Max. ripple 5%

Max. current with overload:	2,5A (900N)	5,0A (1600N)
Operation mode:	S3 30% duty cycle	
Weight w/1000mm stroke:	3,3 kg (900N)	3,5 kg (1600N)
Max. current and time when blocked until interruption by overload:	8A for 200 ms (900N)	13A for 180 ms (1600N)
Accessories for mounting:	Top bracket FB8: #99250111	Motor bracket KB10: #99250110

# Control Panels - Type SVM 24V

5A or 8A / 1 fire-/comfort group

EN12101-10



**Actulux**



### FOR BOTH COMFORT- AND FIRE VENTILATION

SVM "Mini" control panels are constructed to provide and control the operation of the opening systems for comfort and fire ventilation with 24V DC electrical opening units.

The SVM control panel is equipped with connection terminals for external signals (comfort- and fire switches, weather sensor/close all, detectors etc.), and it is also possible to connect more control panels in the same

"Bus" connection. The SVM control panel has a compact and elegant design and is certified according to EN12101-10 class A (double supply).

Incl. battery back-up.

Possibility for built-in fire- and comfort switches in the front.

Specifications	24V Control Panels Mini Type SVM 24V-5A / SVM 24V-8A (VdS approval)
Power supply	230V AC - max. 1.5A
Output supply	24V DC
Motor outputs	1 pc. (line detection: 1-4 lines)
Max. total load	5A / 8A
Operating temperature	-15°C - +40°C
Density	IP 54
Battery back-up (72h)	Yes
Dimensions WxDxH / Weight incl. batteries	238 x 113 x 286 mm / 7,5 kg
Colour	White front - black indication label
Batteries	2 pcs. 12V/7.2AH
Fire groups	1 pc. with line detection. Max. power consumption for fire switches (LED+buzzer) = 17.6mA ≈ approx. 8 fire switches
Comfort groups	1 pc. - unlimited no. of comfort switches
Detector (smoke/heat) inputs	1 pc. with line detection. Max. power consumption for detectors = 2.2mA ≈ approx. 22 pcs. detectors
Weather sensor input / close all	Yes
Alarm output	Yes - potential free contact, max. 48V / 0.5A
Failure output	Yes - potential free contact, max. 48V / 0.5A
24V DC for external use	24V DC / max. 0.5A - at 230V AC operation
Bus communication	Yes - connection of 2 - 35 pcs. control panels - line detection
Visual (LED) indication in front panel	"OK" / "AC fault" / "Low battery" / "Line fault" / "Alarm" / "Comfort open"
DIP switch features (standard)	"Service hours (LED's flash in front panel)" / "Comfort opening interval" / "Temperature detection via motor output" / "Extra line detection via 3 wire motor output" / "Fail safe (alarm by line failure)" / "Sprinkler (close by alarm)" / "Bus comm. setting (react on Bus comm.)" / "Potential free contact for comfort open"
Approvals / Conforms	EN12101-10:2005 approved and certified - class A (double supply) - envir. class 1 (to -15°C) Conform EN12101-9 VdS Certifikat G 518001 (ONLY 8A-edition) VdS 2581:2002-09(02) Umweltklasse III / VdS 2593:2002-09(02) Umweltklasse III



# Control Panels - Type SV 24V/48V

8A, 24A, 30A or 32A - 2 fire-/comfort groups

EN12101-10



**Actulux**



### FOR BOTH FIRE- AND COMFORT VENTILATION

SV control panels are constructed to provide and control the operation of the opening systems for comfort and fire ventilation with 24V or 48VDC electrical opening units.

The SV control panel is equipped with connection terminals for external signals (comfort- and fire switches, weather sensor/close all, detectors etc.), and it is also

possible to connect more control panels in the same "bus" connection.

The SV control panel has a compact and elegant design and in the "ds" version it is certified according to EN12101-10 class A (double supply). Incl. battery back-up.



Specifications	SV 24V-xx Control Panels	SV 48V-xx Control Panels
	SV 24V-24A / SV 24V-32A 24V-8A-ds / 24V-24A-ds / 24V-30A-ds / 24V-32A-ds	48V-24A / 48V-32A 48V-8A-ds / 48V-24A-ds / 48V-30A-ds / 48V-32A-ds
Note / Approvals / Conforms	"-ds" = EN12101-10:2005 approved / certified - class A (double supply) - envir. class 1 (to -15°C) // Conform EN12101-9	
Power supply	230VAC / max. 1.5A ("ds" = max. 5A)	230VAC / max. 1.5A ("ds" = max. 10A)
Output supply	24VDC	48VDC
Motor outputs	2 pcs. (line detection: 1-10 lines)	2 pcs. (line detection: 1-10 lines)
Max. total load	8A / 24A / 30A / 32A	8A / 24A / 30A / 32A
Max. load each motor output	16A	16A
Operating temperature	-15°C - +40°C	-15°C - +40°C
Density	IP 54	IP 54
Battery back-up (72h) / Batteries	Yes / 8A-24A = 2 pcs. 12V/7.2Ah 30A-32A = 2 pcs. 12V/12Ah	Yes / 8A-24A = 4 pcs. 12V/7.2Ah 30A = 2 pcs. 12V/7.2Ah + 2 pcs. 12V/12Ah 32A = 4 pcs. 12V/12Ah
Dimensions (WxDxH) / Weight incl. batteries	343 x 178 x 450 mm / max. 22 kgs	343 x 178 x 450 mm / max. 32 kgs
Colour	White front / Black chassis	
Fire groups	1 or 2 pcs. (by dip switch) with line detect. / Max. power consumption for fire switches (LED+buzzer)=14mA=approx. 6 fire switches	
Comfort groups	1 or 2 pcs. (by dip switch) - Unlimited number of comfort switches	
Detector (smoke/heat) input	2 pcs. with line detection / Max. power consumption for detectors = 4.4 mA = approx. 2x22 = 44 detectors	
Weather sensor input / close all	Yes	Yes
Alarm output	Yes - potential free contact, max. 48V / 0.5A	Yes - potential free contact, max. 48V / 0.5A
Failure output	Yes - potential free contact, max. 48V / 0.5A	Yes - potential free contact, max. 48V / 0.5A
24V DC for external use	24VDC / max. 0.5A - at 230VAC operation	24VDC / max. 0.5A - at 230VAC operation
Bus communication	Yes - connection of 2-10 control panels - line detection	
Visual (LED) indication in front panel	"OK" / "AC fault" / "Low battery" / "Line fault" / "Alarm"	
Dip switch features (standard)	"Service hours (LED's flash in front panel)" / "Comfort opening interval" / "Temperature detection via motor output" / "Extra line detection via 3 wire motor output" / Fail safe (alarm by line failure)" / "Sprinkler (close by alarm)" / "Bus comm. settings (react on Bus comm.)"	

In compliance with Regulation (EU) No 305/2011 of the European Parliament and of the Council of 9 March 2011 (the Construction Products Regulation or CPR), this certificate applies to the construction products

## Power supplies

for use in integrated control panels to smoke and heat control systems, with specification and performance as specified on page 2 in this certificate.

### Product name: SV, SVM and DFM

placed on the market under the name or trademark of

#### Actulux A/S

Haandværkervej 2  
DK-9560 Hadsund, Denmark

and produced in the manufacturing plant

same as above

This certificate attests that all provisions concerning the assessment and verification of constancy of performance described in annex ZA of the standards

### EN 12101-10:2005 and EN 12101-10:2005/AC:2007

under system 1 for the performance set out in this certificate are applied and that the factory production control conducted by the manufacturer is assessed to ensure the

### constancy of performance of the construction product.

This certificate was first issued on 2013-03-14 and will remain valid as long as neither the harmonised standard, the construction product, the AVCP methods nor the manufacturing conditions in the plant are modified significantly, unless suspended or withdrawn by the notified product certification body.

Issued by notified body 0402

The validity of this certificate can be verified on our website.



Johan Åkesson  
Product Certification Manager



Martin Tillander  
Project Manager

Certificate 0402-CPR-SC0354-13 | issue 4 | 2018-09-08

RISE Research Institutes of Sweden AB | Certification  
Box 857, SE-501 15 Borås, Sweden  
Phone: +46 10-516 50 00  
certifiering@ri.se | www.ri.se



This document may not be reproduced other than in full, except with the prior written approval by RISE Certification.

Page 1 (2)

## Specification and performance

Type	Class	Environmental class
SVM 24V-5A	A	1
DFM 24V-5A		
SVM 24V-8A		
DFM 24V-8A		
SV24V-8A		
SV 24V-24A		
SV 24V-30A		
SV 24V-32A		
SV 48V-8A		
SV 48V-24A		
SV 48V-30A		
SV 48V-32A		

Certificate 0402-CPR-SC0354-13 | issue 4 | 2018-09-08

RISE Research Institutes of Sweden AB | Certification



This document may not be reproduced other than in full, except with the prior written approval by RISE Certification.

Page 2 (2)





# Actulux

Actulux A/S | Haandvaerkervej 2 | DK 9560 Hadsund | Tel.: +45 98 57 40 90 | [info@actulux.com](mailto:info@actulux.com) | [www.actulux.com](http://www.actulux.com)